

# CLEANER DELTA 138.2

## GENERAL

Brand	Cimbria
Designation	Air-screen cleaner
Model	DELTA 138.2
Use	Industry
Application	Pre cleaning of grass seeds and similar seeds.

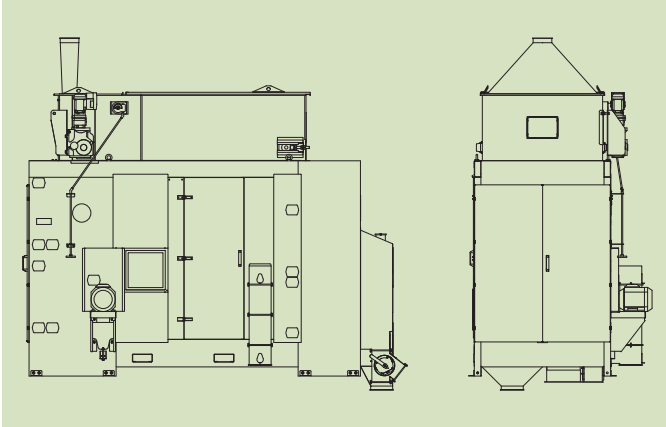

## PERFORMANCE

	Bulk density t/m <sup>3</sup>	Moisture content %	Capacity t/h
Alfalfa	0.75	12	12
Clover	0.75	12	12
Rapeseed	0.74	9	12
Red fescue	0.3	12	7.5
Ryegrass	0.35	12	10
Timothy	0.4	12	5

Note: Capacities may vary for different impurity and moisture contents.

## DIMENSIONS

Screen area, total	18 m <sup>2</sup>
Screen size	1 250×800mm (18 pcs)
Overall length	4 190 mm
Overall height	3 854 mm
Overall width	2 000 mm

## WEIGHT

Weight, empty	3 430 kg
Weight, operating (ryegrass)	3 860 kg
Weight, choked (ryegrass)	5 855 kg

## OPERATING SPEED

Belt feeder (shaft)	1.1–5.6 rpm
Screens (shaft)	300 rpm

## ELECTRICAL RATINGS

Motor, belt feeder	0.37 kW
Motor, screens	3 kW

## AIR SUPPLY AND EXTRACTION

Aspiration volume, screens (top)	2 000 m <sup>3</sup> /h
Aspiration volume, good seed	500 m <sup>3</sup> /h
Aspiration volume, scalplings (1 <sup>st</sup> )	500 m <sup>3</sup> /h
Aspiration volume, scalplings (2 <sup>nd</sup> )	500 m <sup>3</sup> /h

## DYNAMIC LOADS

Horizontal load "Ph"	±1 259 N @ 4.6–4.8 Hz
Vertical load "Pv1" (inlet end)	±2 552 N @ 4.6–4.8 Hz
Vertical load "Pv2" (outlet end)	±2 582 N @ 4.6–4.8 Hz

Note: Dynamic loads are for normal operation.

## NOISE

Sound pressure level, empty	81.6 dB(A)
-----------------------------	------------

## COMPLIANCE

EU machinery legislation	Yes
EU ATEX legislation	Option*
EU food contact legislation	Option*

\* Consult your Cimbria dealer for full details.

## ENVIRONMENTAL CONDITIONS

Environment	Indoors
Temperature	From -20°C to +40°C
Altitude	Up to 800 m

## SURFACE PROTECTION

Frame and enclosure	Paint (corrosivity category C2; low durability)
---------------------	---

## LIFETIME

Intended life limit	20 years
---------------------	----------