

PRE-CLEANER DELTA 138.3

The Delta 138.3 grass seed pre-cleaner is specially designed for pre-cleaning of grass seeds and similar types of seeds with a relatively large content of waste products. The grass seed pre-cleaner include shaker feeder or band conveyer, thresher or after-suction system.

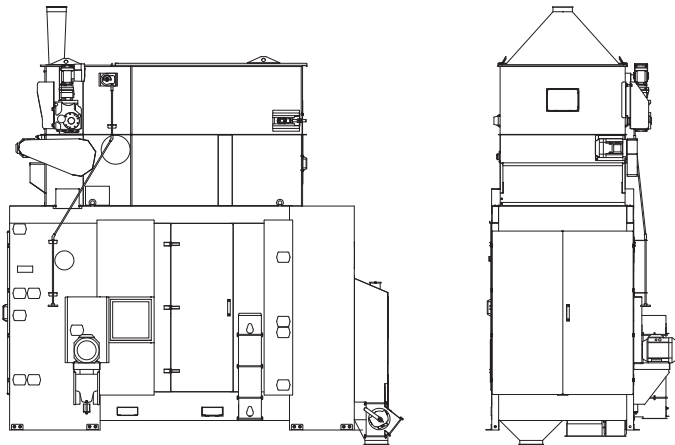

ELECTRICAL RATINGS

Motor, belt feeder	0.37 kW
Motor, thresher	3 kW
Motor, screens	3 kW

AIR SUPPLY AND EXTRACTION

Aspiration volume, screens (top)	2 000 m ³ /h
Aspiration volume, good seed	500 m ³ /h
Aspiration volume, scalpings (1 st)	500 m ³ /h
Aspiration volume, scalpings (2 nd)	500 m ³ /h

DYNAMIC LOADS

Horizontal load "Ph"	±1 259 N @ 4.6–4.8 Hz
Vertical load "Pv1" (inlet end)	±2 552 N @ 4.6–4.8 Hz
Vertical load "Pv2" (outlet end)	±2 582 N @ 4.6–4.8 Hz

Note: Dynamic loads are for normal operation.

PERFORMANCE

Materials	Bulk density t/m ³	Moisture content %	Capacity t/h
Alfalfa	0.75	12	12
Bluegrass	0.2	12	4
Clover	0.75	12	12
Rapeseed	0.74	9	12
Red fescue	0.3	12	7.5
Ryegrass	0.35	12	10
Timothy	0.4	12	5

Note: Capacities may vary for different impurity and moisture contents.

DIMENSIONS

Screen area, total	18 m ²
Screen size	1 250×800 mm (18 pcs)
Overall length	4 190 mm
Overall height	4 601 mm
Overall width	2 000 mm

WEIGHT

Weight, empty	3 940 kg
Weight, operating (ryegrass)	4 370 kg
Weight, choked (ryegrass)	7 250 kg

OPERATING SPEED

Belt feeder (shaft)	1.1–5.6 rpm
Thresher (shaft)	520 rpm
Screens (shaft)	300 rpm

NOISE

Sound pressure level, empty	81.6 dB(A)
-----------------------------	------------

COMPLIANCE

EU machinery legislation	Yes
EU ATEX legislation	Option*
EU food contact legislation	Option*

** Consult your Cimbria dealer for full details.*

ENVIRONMENTAL CONDITIONS

Environment	Indoors
Temperature	From -20°C to +40°C
Altitude	Up to 800 m

SURFACE PROTECTION

Frame and enclosure	Paint (corrosivity category C2; low durability)
---------------------	---

LIFETIME

Intended life limit	20 years
---------------------	----------