

GRADER DELTA 122

GENERAL

Brand	Cimbria
Designation	Flat-screen grader
Model	DELTA 122
Use	Industry
Application	Size grading of cereal grains, pulses, oilseeds, and similar seeds intended for seed.

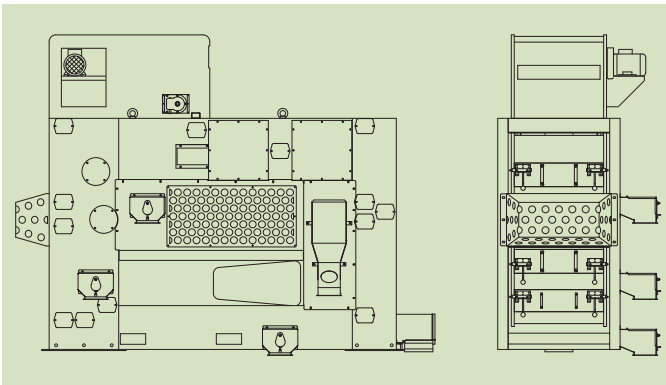

PERFORMANCE

	Bulk density t/m ³	Moisture content %	Capacity t/h
Barley	0.68	14	1.5
Coffee, green	0.65	14	0.8–1.6
Maize	0.71	14	1–2
Oats	0.51	14	1
Peas, common	0.7	14	1–2
Rice, white	0.75	14	2
Rye	0.69	14	1.5
Ryegrass	0.3	14	0.4
Sorghum	0.64	14	1.5
Soybeans	0.72	14	1–2
Sunflower	0.4	7–9	0.5–1.5
Wheat	0.76	14	1.5

Note: Capacities are for grading three to four fractions. Capacities may vary for different number of grades.

DIMENSIONS

Screen area, total	3 m ²
Screen size	625×800 mm (6 pcs)
Overall length	3 018 mm
Overall height	2 270 mm
Overall width	1 172 mm

WEIGHT

Weight, empty	1 060 kg
Weight, operating (wheat)	1 100 kg
Weight, choked (wheat)	2 210 kg

OPERATING SPEED

Shaker feeder (shaft)	140–700 rpm
Screens (shaft), fixed speed	280–285 rpm
Screens (shaft), variable speed	260–320 rpm

ELECTRICAL RATINGS

Motor, shaker feeder	0.75 kW
Motor, screens	1.5 kW

AIR SUPPLY AND EXTRACTION

Aspiration volume	500–1 500 m ³ /h
-------------------	-----------------------------

DYNAMIC LOADS

Horizontal load "Ph"	±200 N @ 4.6–4.8 Hz
Vertical load "Pv1" (inlet end)	±1 000 N @ 4.6–4.8 Hz
Vertical load "Pv2" (outlet end)	±1 000 N @ 4.6–4.8 Hz

Note: Dynamic loads are for normal operation.

NOISE

Sound pressure level, empty	79.3 dB(A)
-----------------------------	------------

COMPLIANCE

EU machinery legislation	Yes
EU ATEX legislation	Option*
EU food contact legislation	Option*

* Consult your Cimbria dealer for full details.

ENVIRONMENTAL CONDITIONS

Environment	Indoors
Temperature	From -20°C to +40°C
Altitude	Up to 800 m

SURFACE PROTECTION

Frame and enclosure	Paint (corrosivity category C2; low durability)
---------------------	---

LIFETIME

Intended life limit	20 years
---------------------	----------