

CHAIN CONVEYOR TYPE RM

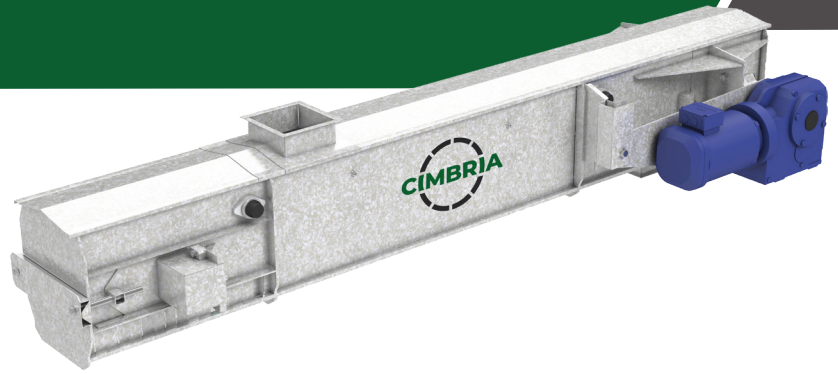

GENERAL

Brand	Cimbria
Model	RM Chain Conveyor
Capacity range	334–1 306 m ³ /h
Chain speed	up to 0.60 m/s
Application	Moving dry bulk materials, such as grains and grain-like products

Cimbria type RM chain conveyor is designed for moving dry bulk materials, such as grains and grain-like products, but can successfully be used to transport other materials, such as granulate, shavings etc. Cimbria will assist with consulting.

The conveyor can be arranged with several slide gates for material outlets. It can be configured for reversible operation and has a very large capacity.

Curved back plate used with return buckets can ensure that the material does not accumulate at the end of the conveyor.

Intermediate sections with double bottom and raised cover can be equipped with capacity regulation.

FEATURES

- Single bottom casing with return rollers or double bottom casing
- Dual-side or top loading
- Single or double strand conveyor chain, pins-and-bush assembly; data sheet: *Conveyor Chain*
- Welded flights with bolted scraper flaps
- Manual chain tensioning at tail end
- Wear plates on bottom

DRIVE SYSTEM

- Parallel shaft helical gearmotor, hollow shaft
- Gearmotor mounted on right or left hand side as specified
- Electrical soft starter >15 kW (highly recommended)

CONTROLLERS

- Overflow sensing
- Rotation sensing (optional)
- Bearing heat sensing (optional)
- Explosion relief (optional); data sheet 50

ACCESSORIES

- Outlet for Q-pipe system
- Top covers for inlet sections
- Slide gates; data sheet: *Slide Gate Type RL/RS/RM*
- Return buckets for chain
- Inspection windows
- Wear plates along lower sides
- Sun cover for gearmotor
- Support system; data sheet: *Chain Conveyor Support System*
- Centre drive
- Air cleaning

Technical data

Maximum capacity	RM-10	334 m ³ /h
	RM-12	505 m ³ /h
	RM-14	821 m ³ /h
	RM-16	1 306 m ³ /h
Maximum bulk density	850 kg/m ³	
Drive motor size	According to application	
Chain speed	Up to 0.60 m/s	
Sound pressure level	75 to 85 dB(A)	
Maximum length and angle of slope	Depends on the material properties and the length and angle of the conveyor	
Operating conditions	Indoor and outdoor -15°C to +40°C ambient	

NOTE: All capacities in the above table are based on the handling of dry and cleaned wheat.

Materials

Casing	Standard	RM-10, -12 RM-14, -16	Pre-galvanised steel Hot-dip galvanised steel
	Optional		Hot-dip galvanised steel Stainless steel Painted steel
Wear plates, bottom			PE-UHMW, antistatic, 10 mm
Wear plates, sides	Optional		Hardox® steel, 4 or 6 mm
Chain			Steel, oil coated
Rollers			Steel, oil coated
Scraper flaps			PE-UHMW, antistatic

Compliance

Atex	Standard	Non-zone inside Non-zone outside
	Optional	Zone 22 or 21 inside Zone 22 or 21 outside

NOTE: Specific requirements apply for ATEX compliance.

CHAIN CONVEYOR TYPE RM

DIMENSIONS

RM-10, RM-12

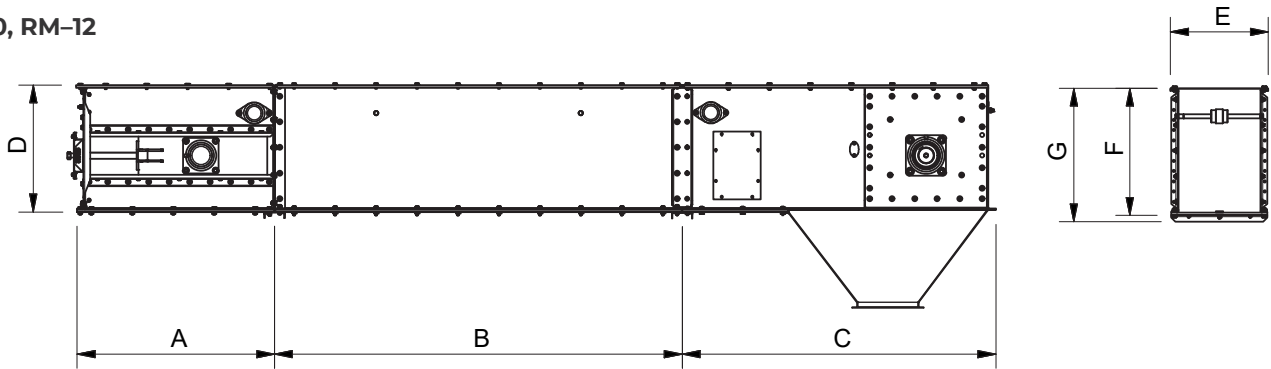

RM-14, RM-16

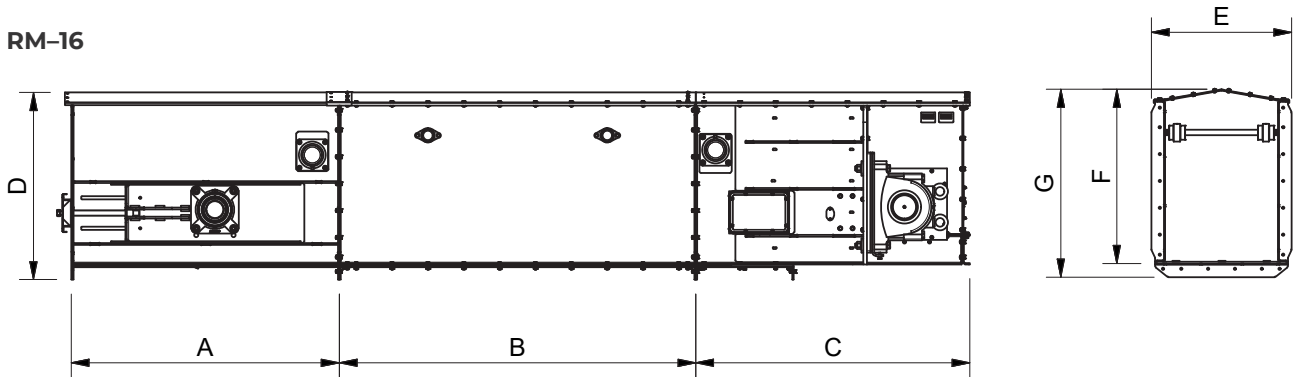

	A [mm]	B [mm]	C [mm]	D [mm]	E [mm]	F [mm]	G [mm]
RM-10	964	490 / 990 / 1990 / 3 000	1 530	620	477	622	652
RM-12	970	490 / 990 / 1990 / 3 000	1 530	736	595	736	756
RM-14	1 496	490 / 990 / 1990	1 530	1 045	782	972	1 048
RM-16	1 496	490 / 990 / 1990	1 530	1 282	952	1 212	1 282

	Grain layer thickness [mm]	Grain layer width [mm]	Thickness, top plate [mm]	Thickness, side plate [mm]	Thickness, bottom plate [mm]	Weight with material [kg/m] ¹	Driving section [kg] ²	Intermediate section [kg/m]	Tension section [kg]
RM-10	420	400	2.5	4	4	255	260	115	220
RM-12	530	500	2.5	4	4	355	265	145	240
RM-14	660	630	2.5	6	6	570	1100	250	800
RM-16	850	800	3.0	6	6	800	1350	290	1120

[¹] With material bulk density 760 kg/m³

[²] Weight of driving section without motor