

CHAIN CONVEYOR TYPE RW

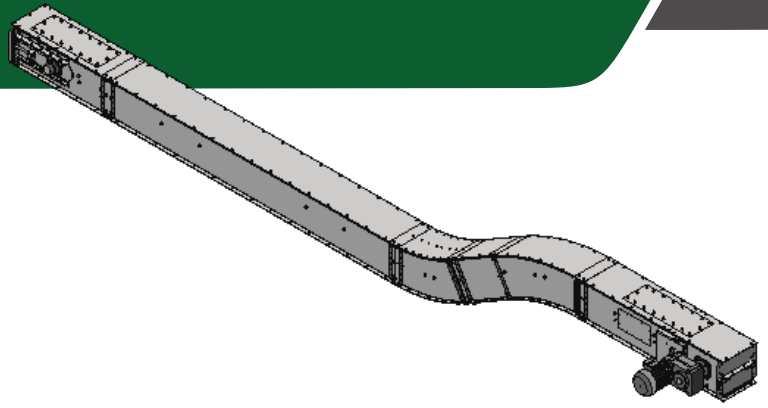

GENERAL

| | |
|-------------|---|
| Brand | Cimbria |
| Model | RW Chain Conveyor |
| Chain speed | up to 0.27 m/s |
| Application | Moving dry bulk materials, such as sawdust, shavings and cereal residue |

Cimbria type RW chain conveyor is designed for moving dry bulk materials such as sawdust, shavings and cereal residue.

The conveyor can be arranged for horizontal *and* inclined travel in one process, which makes for a cost-effective and efficient solution, in that one machine can accomplish what generally requires two.

The conveyor can be configured for reversible operation.

FEATURES

- Single bottom casing with chain runners
- Dual-side or top loading
- Single strand conveyor chain; pins-and-bush assembly; data sheet 102.02.101
- Welded flights with bolted rubber flaps
- Manual chain tensioning at tail end

DRIVE SYSTEM

- Parallel shaft helical gearmotor, hollow shaft
- Gearmotor mounted on right or left hand side

CONTROLLERS

- Overflow sensing
- Rotation sensing
- Bearing heat sensing (optional)
- Explosion relief (optional); data sheet 50

ACCESSORIES

- Outlet for Q-pipe system
- Top covers for inlet sections
- Inspection windows
- Sun cover for gearmotor
- Support system; data sheet 102.02.102

Technical data

| | | |
|-----------------------------------|---|----------------------|
| Maximum capacity | Horizontal | 30 m ³ /h |
| | Angled (90°) | 15 m ³ /h |
| Maximum bulk density | 200 kg/m ³ | |
| Drive motor size | According to application | |
| Chain speed | Up to 0.27 m/s | |
| Sound pressure level | 75 to 85 dB(A) | |
| Maximum length and angle of slope | Depends on the material properties and the length and angle of the conveyor | |
| Operating conditions | Indoor and outdoor -15°C to +40°C ambient | |

Materials

| | | |
|---------------|----------------------|--|
| Casing | Pre-galvanised steel | |
| Chain | Steel, oil coated | |
| Chain runners | PEHD, antistatic | |
| Rubber flaps | SBR, antistatic | |

Compliance

| | | |
|------|----------|------------------------------------|
| Atex | Standard | Zone 21 inside Non-zone outside |
| | Optional | Zone 22 or 21 outside |

NOTE: Specific requirements apply for ATEX compliance.

CHAIN CONVEYOR TYPE RW

DIMENSIONS

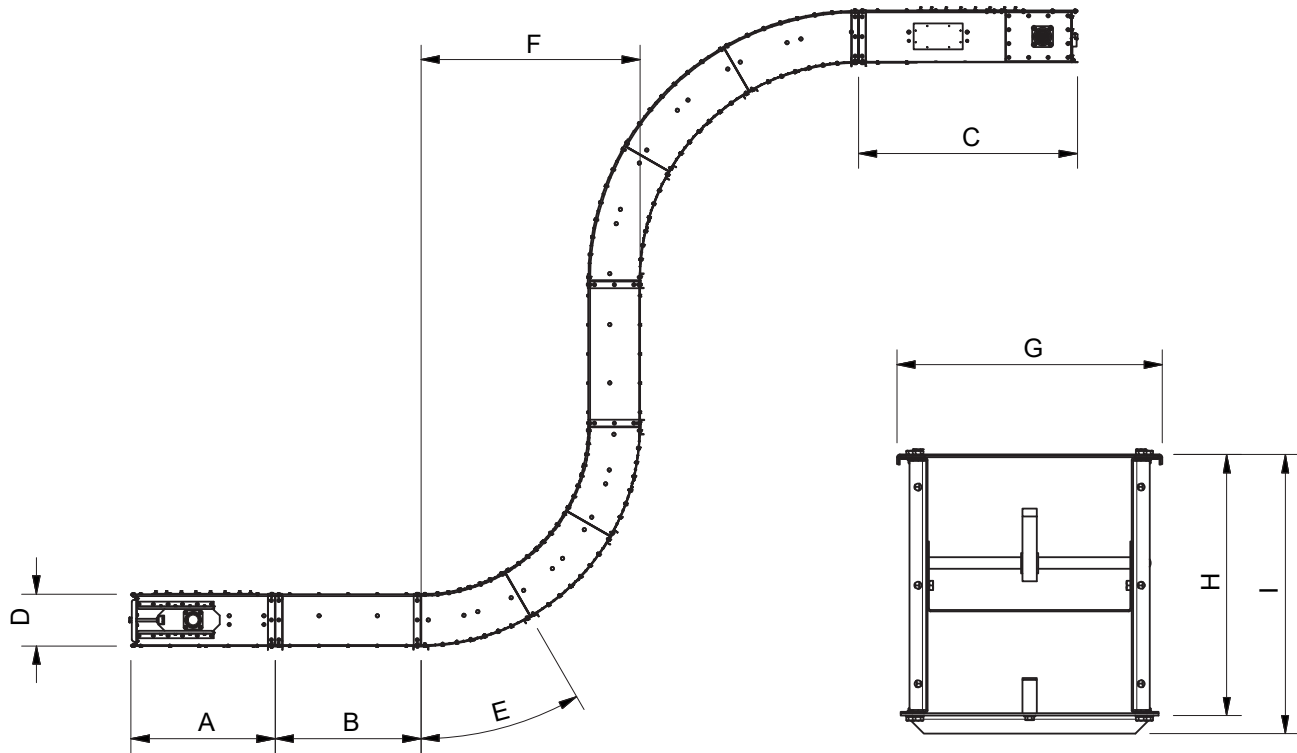

| | A [mm] | B [mm] | C [mm] | D [mm] | E [mm] | F [mm] | G [mm] | H [mm] | I [mm] |
|--------------|-----------|------------------------|-----------|-----------|-----------|-----------|-----------|-----------|-----------|
| RW-30 | 990 | 500 / 1 000 / 3 000 | 1 500 | 356 | 15° / 30° | 1 500 | 364 | 358 | 383 |

| | Grain layer thickness [mm] | Grain layer width [mm] | Thickness, top plate [mm] | Thickness, side plate [mm] | Thickness, bottom plate [mm] | Weight with material [kg/m] ¹ | Driving section [kg] ² | Intermediate section [kg/m] | Tension section [kg] |
|--------------|----------------------------------|---------------------------|------------------------------|----------------------------------|------------------------------------|--|---|-----------------------------------|----------------------------|
| RW-30 | Up to 110 | 280 | 2 | 3 | 3 | 6.2 | 132 | 28 | 55 |

[¹] With material bulk density 200 kg/m³

[²] Weight of driving section without motor