

BELT CONVEYOR TRIPPER FOR GT

GENERAL

Brand Cimbria
Model Tripper for GT

Cimbria Tripper is used when the belt conveyor is going to discharge material in several places.
The Tripper moves on wheels on the conveyor rails.
The Tripper can be manually operated or motorized.

The material is discharged through a spout with two-way valve (as standard).
The speed of the Tripper is 16 m/min.

Manual operated Tripper

The manually operated Tripper is delivered with two built in hand brakes. The Tripper is built as a closed unit with built in wheels.

Motorized Tripper

There is a low transmission of the motorized Tripper. The chain drive between wheels ensures stable positioning. The discharge spout is supplied with a two-way valve and a limit switch. The Tripper is built as a closed unit with built in wheels.

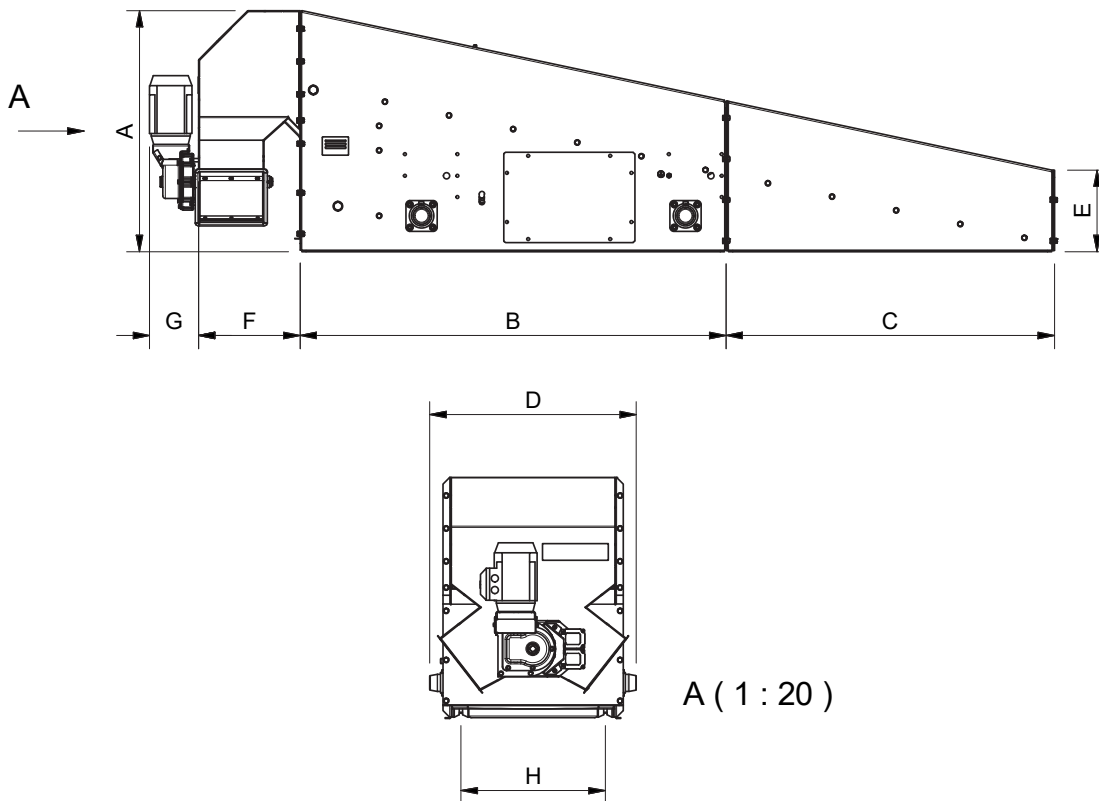

Dimensions:

	A [mm]	B [mm]	C [mm]	D [mm]	E [mm]	F [mm]	G [mm]	H [mm]	Weight [kg]
GT-400	908	1 304	998	630	294	351	153	440	190
GT-500	908	1 304	998	730	294	351	153	540	234
GT-650	1 054	1 504	1 159	880	344	411	153	690	367