

# BELT CONVEYOR TYPE GT



## GENERAL

Brand	Cimbria
Model	GT belt conveyor
Capacity range	100–262 m <sup>3</sup> /h
Belt speed	up to 2.00 m/s
Application	Conveying of loose bulk materials, such as grains, pulses and pellets

Cimbria type GT belt conveyor is designed for continuously conveying of loose bulk materials, such as grains, pulses and pellets.

The conveyor consists of galvanized curved plates, bolted. The conveyor uses a troughed belt to move the material from the loading point to the unloading point.

The conveyor can be arranged for horizontal or inclined travel, the angle of slope depending on the conveyed material and the type of belt.

The conveyor can be configured for reversible operation.

## FEATURES

- Solid drive pulley with/without rubber lagging or '3M' lagging
- Trailing pulley with slide plates
- Carrying idlers for belt
- Return idlers
- Tripper, manually or motorized, data sheet: *Belt Conveyor Tripper for GT*
- Troughed belt

## DRIVE SYSTEM

- Parallel shaft helical gearmotor, hollow shaft
- Helical bevel gearmotor, hollow shaft (optional)
- Gearmotor mounted on right or left hand side as specified

## CONTROLLERS

- Rotation sensing.
- Pull cord operated emergency stop (optional)
- Bearing heat sensing (optional)
- Misalignment detectors (optional)
- Tripper position sensing (optional)

## ACCESSORIES

- Equipotential bonding of shafts
- Inlet modules
- Outlet with belt scraper
- Brush
- Belt weigher
- Top and bottom covers for intermediate section
- Weight tension (>100 m)
- Support system; data sheet: *Belt Conveyor Support System*

## Technical data

Maximum capacity	GT-400	100 m <sup>3</sup> /h
	GT-500	160 m <sup>3</sup> /h
	GT-650	262 m <sup>3</sup> /h
Maximum bulk density	850 kg/m <sup>3</sup>	
Drive motor size	According to application	
Belt speed	Up to 2.00 m/s	
Sound pressure level	77 to 82 dB(A)	
Maximum length and angle of slope	Depends on the material properties and the length and angle of the conveyor	
Operating conditions	Indoor and outdoor	
	-15°C to +40°C ambient	

NOTE: All capacities in the above table are based on the handling of dry and cleaned wheat.

## Materials

Casing	Standard	Pre-galvanised steel
	Optional	Stainless steel
Belt type	Standard	Smooth belt
	Optional	Chevron cleated belt
		Crescent belt
Belt quality	Standard	Regular belt, antistatic, (SBR)
	Optional	Oil-resistant belt 'GM', antistatic (SBR/NBR)
		FDA compliant belt, white, oil-resistant 'GM', antistatic (SBR/NBR)
Splicing method	Standard	Endless splicing
		Open

## Compliance

Atex	Standard	Non-zone inside
		Non-zone outside
	Optional	Zone 22 or 21 inside
		Zone 22 or 21 outside

NOTE: Specific requirements apply for ATEX compliance.

# BELT CONVEYOR TYPE GT

## DIMENSIONS

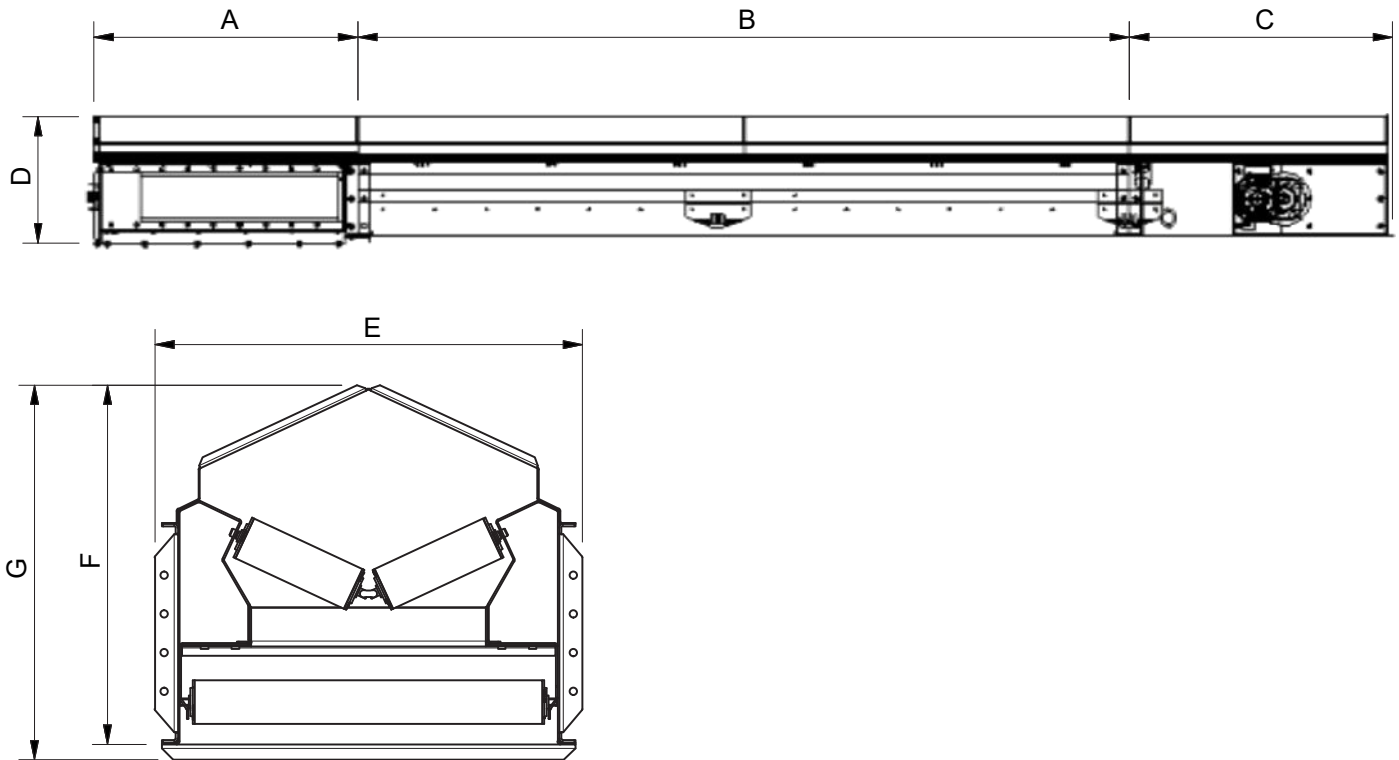

	A [mm]	B [mm]	C [mm]	D [mm]	E [mm]	F [mm]	G [mm]	
<b>GT-400</b>	1 025	500 / 1 000 / 3 000	1 025	492	554	465	485	
<b>GT-500</b>	1 025	500 / 1 000 / 3 000	1 025	515	654	485	505	
<b>GT-650</b>	1 025	500 / 1 000 / 3 000	1 025	552	804	530	550	

	Belt type	Belt width [mm]	Belt thickness [mm]	Strength [N/mm]	Inlet/outlet flange	Weight with material [kg/m] <sup>1</sup>	Driving section [kg] <sup>2</sup>	Intermediate section [kg/m]	Tension section [kg]
<b>GT-400</b>	EP 200/2 2+1	400	5.2	20	Q20	11	70	30	70
<b>GT-500</b>	EP 200/2 2+1	500	5.2	20	Q24	17	75	32	75
<b>GT-650</b>	EP 200/2 2+1	650	5.2	20	Q30	28	115	35	115

[<sup>1</sup>] With material bulk density 760 kg/m<sup>3</sup>

[<sup>2</sup>] Weight of driving section without motor